

产品编码解析 Explanation of Part Number

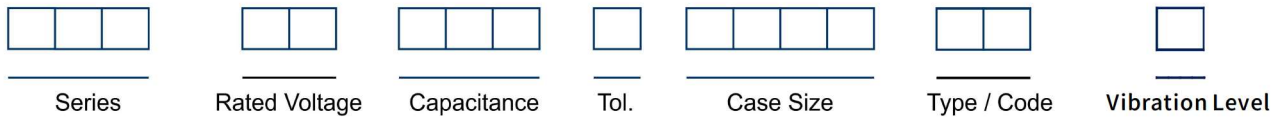

Aluminum Electrolytic Capacitor

Series	R.W. Voltage (V)	Code	Capacitance (μF)	Code	Cap Tol	Code	Case Size (mm)	Code	Feature	Code
VS1							RADIAL		RADIAL TYPE	
VT1	2.5	0E	0.1	0R1	±5%	J	4×5	0405	Radial bulk	B1
VT2	4	0G	0.22	R22			5×5	0505		
VTD	6.3	0J	0.33	R33	±10%	K	6.3×5	0605		
VTG	10	1A	0.47	R47			4×7	0407		
VZ2	16	1C	1	010	±15%	Y	5×7	0507	Ammo Taping (P11~12)	F1
VTK	25	1E	2.2	2R2			6.3×7	0607		F2
VTL	35	1V	3.3	3R3	±20%	M	8×7	0807		F3
VUL	50	1H	4.7	4R7			5×11	0511		
VBP	63	1J	10	100	+30%		6.3×11	0611		
VLD	80	1K	22	220	-10%	Q	8×12	0812		
MS1	100	2A	33	330			8×14	0814	Lead Cut & Form (P13)	
MT1	125	2B	47	470			10×12	1012		C1
MBP	160	2C	100	101	Others	T	10×16	1016		CB
SS1	180	2J	220	221			10×20	1020		CK
ST1	200	2D	330	331			13×20	1320		CN
SBP	220	2P	470	471			16×25	1625		CM
STL	250	2E	1000	102			16×32	1632		
RS1	315	2F	2200	222			16×36	1636		
RT1	330	2U	3300	332			18×20	1820	V-CHIP TYPE (P14)	
RLL	350	2V	47000	473			18×26	1826		
RTE							18×36	1836		
RTZ							SMD			V1
RCL	2.5	0E	33	330	±5%	J	4×5.4	0405		V2
RXG	4	0G	47	470			5×5.4	0505		VP
RXZ	6.3	0J	68	680	±10%	K	6.3×5.4	0605		VC
LSS	10	1A	100	101			6.3×7.7	0607		
LHS	16	1C	220	221	±20%	M	8×6.2	0806		
LHK	25	1E	390	391			8×10.2	0810		
LHA	35	1V	470	471			10×10.2	1010		
	50	1H	560	561			12.5×13.5	1213		

Conductive Polyer Aluminum Solid Electrolytic Capacitor

Series	R.W. Voltage (V)	Code	Capacitance (μF)	Code	Cap Tol	Code	Case Size (mm)	Code	Feature	Code
VPX	2.5	0E	33	330	±5%	J	RADIAL		RADIAL TYPE	
VPT	4	0G	47	470			5×7	0507	Radial bulk	B1
VPZ	6.3	0J	68	680	±10%	K	5×8	0508		
VPG	10	1A	100	101			5×9	0509	Ammo Taping (P11~12)	F1
VPQ	16	1C	220	221			6.3×6	0606		F2
RPX	25	1E	330	331	±20%	M	6.3×7	0607		F3
RPT	35	1V	470	471			6.3×8	0608		
RPZ	50	1H	560	561			6.3×9	0609		
RPG	63	1J	680	681			6.3×10	0610	Lead Cut & Form (P13)	C1
RPL	80	1K	820	821			8×8	0808		
RPK	100	2A	1200	122			8×10	0810		
RPM	160	2C	1500	152			8×12	0812		
RPC	200	2D	2200	222			8×14	0814	V-CHIP TYPE (P15)	
	250	2E	2700	272			10×12	1012		
			3300	332			SMD			V1
							5×6	0506		
							6.3×6	0606		
							6.3×7	0607		
							8×9	0809		
							8×11.8	0812		
							10×12.7	1012		

编带产品规格 Taping Specifications (Radial Type)

■ Taping Specifications

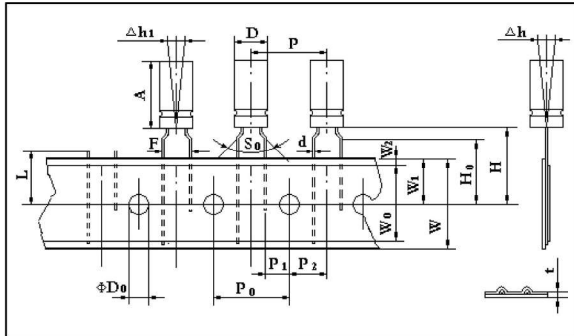

Figure 1

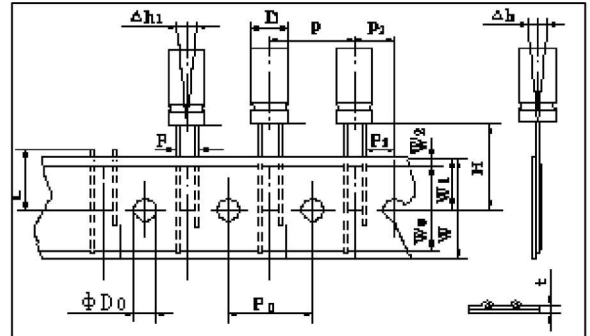

Figure 2

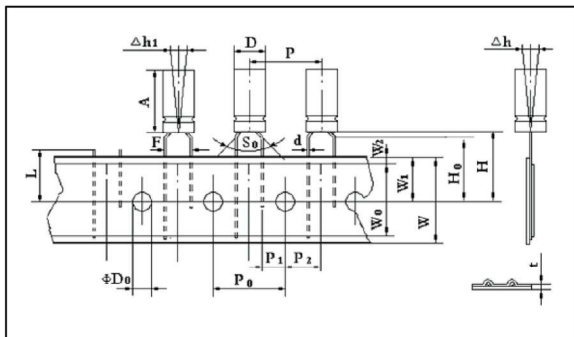

Figure 3

■ Packaging Specification

Diameter	Ammunition	Ammunition packing dimensions(mm)
	Quantity/Box(pcs)	
φ 4	3000	330 × 296 × 49
φ 5	2000	330 × 250 × 49
φ 6.3	2000	330 × 296 × 49
φ 8	1000	330 × 250 × 49

Code F1	Case Size				Tol
	4*5 4*7	5*5 5*7 5*11	6.3*5 6.3*7 6/6.3*11	8*5 8*7 8*11.5	
Reference figure	Figure 1				--
φ d	0.45	0.45 0.5 (5*11)	0.45 0.5 (6*11)	0.45 0.5(8*7) 0.5(8*11.5)	± 0.05
p	12.7				± 1.0
P ₀	12.7				± 0.3
P ₁	3.85				± 0.5
F	5.0				+0.6/-0.2
Δh	0				± 1.0
W	18.0				± 0.5
W ₀	12min				--
W ₁	9.0				± 0.5
W ₂	2.0 max				--
H	18.5 (17.5) *				± 0.5
H ₀	16.0				± 0.5
D ₀	4.0				± 0.3
t	0.6				± 0.2
Δh1	0				± 0.2

Code F2	Case Size					Tol
	4*5 4*7	5*5 5*7 5*11	6.3*5 6.3*7 6/6.3*11	8*5 8*7 8*11.5	ϕ 10	
Reference figure	Figure 2					--
ϕ d	0.45	0.45 0.5 (5*11)	0.45 0.5 (6*11)	0.45 0.5(8*7) 0.5(8*11.5)	0.60	± 0.05
p	12.7					± 1.0
P ₀	12.7					± 0.3
P ₁	5.6	5.35	5.1	4.6	3.85	± 0.5
F	1.5	2.0	2.5	3.5	5.0	+0.6/-0.2
Δ h	0					± 1.0
W	18.0					± 0.5
W ₀	12min					--
W ₁	9.0					± 0.5
W ₂	2.0 max					--
H	18.5 (17.5) *					± 0.5
H ₀	--					--
D ₀	4.0					± 0.3
t	0.6					± 0.2
Δ h1	0					± 0.2

Code F3	Case Size			Tol
	4*5 4*7	5*5 5*7 5*11	8*5 8*7	
Reference figure	Figure 3		Figure 2	--
ϕ d	0.45	0.45 0.5 (5*11)	0.45 0.5(8*7)	± 0.05
p	12.7			± 1.0
P ₀	12.7			± 0.3
P ₁	5.1			± 0.5
F	2.5			+0.6/-0.2
Δ t	0			± 1.0
W	18.0			± 0.5
W _c	12min			--
W ₁	9.0			± 0.5
W ₂	2.0 max			--
H	18.5 (17.5) *			± 0.5
H ₀	16.0		--	± 0.5
D ₀	4.0			± 0.3
t	0.6			± 0.2
Δ h1	0			± 0.2

成型产品规格

Lead Forming Specifications (Radial Type)

■ Lead Forming Specifications

Code		Case Size				Shape Figure
		D	d ± 0.05	s ± 0.5	h	
C	1	φ 4	φ 0.45	1.5	h ± 0.3	
		φ 5	φ 0.45/0.5	2.0		
		φ 6.3	φ 0.45/0.5	2.5		
		φ 8	φ 0.45/0.5	3.5		
C	B	φ 4	φ 0.45	5	h ± 0.3	
		φ 5	φ 0.45/0.5	5	h ± 0.3	
		φ 6.3	φ 0.45/0.5	5	h ± 0.3	
		φ 8	φ 0.45/0.5	5	h ± 0.3	
C	K	φ 4	φ 0.45	1.5	h ± 0.5	
		φ 5	φ 0.45	2.0	h ± 0.5	
		φ 6.3	φ 0.45	2.5	h ± 0.5	
		φ 8	φ 0.45	3.5	h ± 0.5	
φ 0.50						
C	N	φ 4	φ 0.45	1.5	h ± 0.5	
		φ 5	φ 0.45	2.0	h ± 0.5	
		φ 6.3	φ 0.45	2.5	h ± 0.5	
C	M	φ 4	φ 0.45	1.5	h ± 0.5	
		φ 5	φ 0.45	2.0	h ± 0.5	
		φ 6.3	φ 0.45	2.5	h ± 0.5	

Note: "h" depends on customer's requirement.

Taping Specification

For SMD Type Of Aluminum Electrolytic Capacitor

Carrier tape

Specifications	W ±0.30	A	B	P ₁ ±0.10	F ±0.10	t ₂
φ4×5.4	12.0	4.7	4.7	8.0	5.5	5.8
φ5×5.4	12.0	6.0	6.0	12.0	5.5	5.8
φ6.3×5.4	16.0	7.0	7.0	12.0	7.5	5.8
φ6.3×7.7	16.0	7.0	7.0	12.0	7.5	8.3
φ8×6.2	16.0	8.7	8.7	12.0	7.5	6.8
φ8×10.2	24.0	8.7	8.7	16.0	11.5	11.0
φ10×10.2	24.0	10.7	10.7	16.0	11.5	11.0
φ12.5×13.5	32.0	13.4	13.4	24	14.2	14.4
φ12.5×16	32.0	13.4	13.4	24	14.2	16.3
φ16×16.5	44.0	17.5	17.5	28	20.2	17.4
φ16×21.2	44.0	17.5	17.5	28	20.2	22.4

Reel (Paper: V1 ; Plastic: V2 ; Vacuum Packing: VP)

φ	Quantity
4×5.4	2000PCS
5~6.3×5.4~7.7	1000PCS
8×6.2	1000PCS
8~10×10.2	500PCS
12.5×13.5	250PCS
12.5×16	200PCS
16×16.5	200PCS
16×21.5	150PCS

φD	4	5	6.3	8	10	12	16
A	14	14	18	28	28	34	48

Temperature/ Time profile

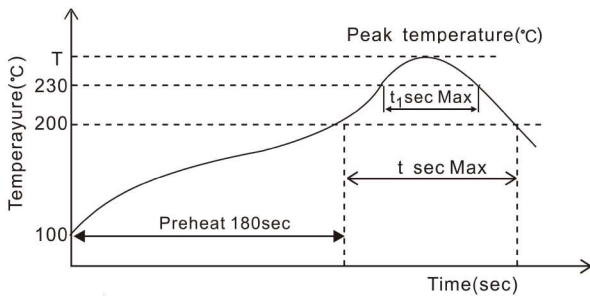

- Preheat shall be done at 100°C~200°C and for maximum 180 seconds.
- The temperature at capacitor top shall not exceed +255°C.
- The duration for over +200°C temperature at capacitor top shall not exceed 110 seconds.
- If capacitors are subject to the conditions other than the allowable range of reflow. please contact us.

Allowable Range of Peak Temperature

Size	T(°C)	t(second)	t ₁ (second)
φ 4~ φ 6.3	255	100	50
φ 8	245	100	40
φ 10~ φ 16	245	90	40

Recommended land size

Vibration Level :C mm

Size	X	Y	a
φ 4	1.6	2.6	1.0
φ 5	1.6	3.0	1.4
φ 6.3	1.6	3.5	2.1
φ 8	2.2	3.9	3.0
φ 10	2.5	4.5	4.0
φ 12	3.0	5.5	5.0
φ 16	3.0	6.5	7.0
φ 18	3.0	7.5	7.0

Vibration Level :G mm

Size	X	Y	a
φ 6.3	3.2	3.6	2.1
φ 8	4.0	4.0	3.0
φ 10	4.5	4.6	4.0
φ 12.5	6.0	5.7	5.0
φ 16	7.5	7.0	6.0

Taping Specification

For SMD Type Of Polymer Solid Capacitor

Carrier tape

Specifications	W ±0.30	A	B	P1 ±0.10	F ±0.10	t2 ±0.15
φ5×6	12.0	6.0	6.0	12.0	5.5	6.3
φ5×8	12.0	6.0	6.0	12.0	5.5	8.5
φ6.3×6	16.0	7.0	7.0	12.0	7.5	6.3
φ6.3×9	16.0	7.0	7.0	12.0	7.5	10.0
φ8×9	24.0	8.7	8.7	16.0	11.5	11.0
φ8×11.8	24.0	8.7	8.7	16.0	11.5	13.0
φ10×12.7	24.0	10.7	10.7	16.0	11.5	14.0

Reel (Paper: V1 ; Plastic: V2 ; Vacuum Packing: VP)

φ D x L	φ 5x6	φ 5x8	φ 6.3x6	φ 6.3x9	φ 8x9	φ 8x11.8	φ 10x12.7
Quantity/Reel	1000	1000	1000	800	500	400	400

mm				
φ D	φ 5	φ 6.3	φ 8	φ 10
A	14	18	26	26

Temperature/ Time profile

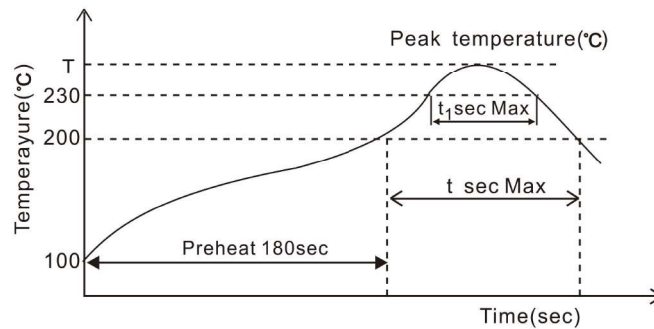

Allowable Range of Peak Temperature

Size	T(°C)	t(second)	t1(second)
φ 4~φ 6.3	250	90	40
φ 8~φ 10	240	90	30

- Preheat shall be done at 100°C~200°C and for maximum 180 seconds.
- The temperature at capacitor top shall not exceed +250°C.
- The duration for over +200°C temperature at capacitor top shall not exceed 90 seconds.
- If capacitors are subject to the conditions other than the allowable range of reflow, please contact us.