

REV	DESCRIPTION	DATE	ECN NO.	CHANGER
A/0	The last word	09.02.05		JACK
A/1	correct dimension	13.01.30	2013024	SALLY

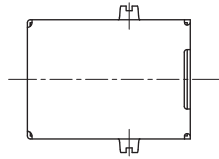

Specification

- 1.Current Rating:1.5AMP at 250V AC  
Voltage Rating:30V
- 2.Insulation Resistance:1000M $\Omega$ , Min
- 3.Contact Resistance:30m $\Omega$ , Max
- 4.Dielectric Withstanding Voltage:500V AC
- 5.Temperature Range:-20°C to +60°C
- 6.Mechanical Characteristics:  
Insertion Force:35 Newtons maximum  
Extraction Force:10 Newtons minimum

P/N NOTE:

USB-B1D08F-XX4X

Shell plate spec:

T=Tin plated, N=Nickel plated

Housing colour:

B=Black, N=Nature, W=White

Contact plate spec:

0=FU", 1=3U", 2=6U",

3=15U", 4=30U"

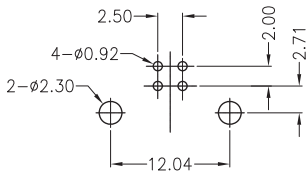
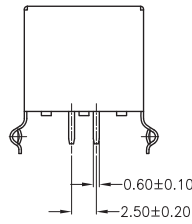
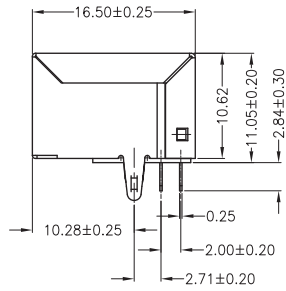
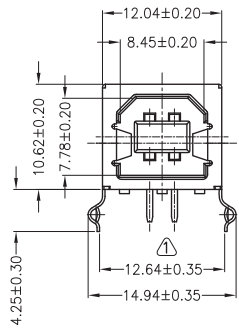

RECOMMENDED P.C.B HOLE LAYOUT  
TOP VIEW(TOLERANCE:±0.10)

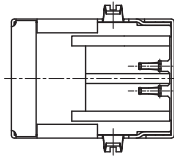

4	Shell	C2680H	1	T=0.25 Plating nickel/Tin
3	Housing	PBT	1	UL94V-0 Nature/Black/White
2	Contact(Long)	C2680H	2	T=0.25 Plating Gold
1	Contact(brief)	C2680H	2	T=0.25 Plating Gold
NO.	VARIETY	MATERIAL	QT,Y	REMARK

CZT<sup>®</sup> DONGGUAN ZHENGDE (YIHUA) CONNECTOR CO., LTD

X: ±0.38	X.i±4'	UNIT:	mm	DR:	SALLY	TITLE:	USB B TYPE(FEMALE)	
.X ±0.25	.Xi±2'	3RD:		DE:	JACK		DIP 90° L=16.50	
.XX±0.20	.XXi±	SCALE:	1:1	CHKD:		SHEET:	1/1	P/N:
.XXX±0.10	.XXXi±	CUSTOMER DRAWING	REV:	A/1	APPD:	D/N:	1114-0008	M/N:
								USB-B1D08F-XX4X