

<b>MODEL</b>	<b>SPECIFICATION</b>	SP-001	Page
R9 Series Thru Hole			RoHS Compliant -Rotary Coded Switch

**Order Information:**

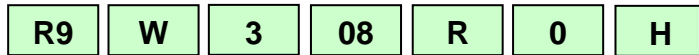

**Terminal:**  
H=Thru Hole  
T=THR(Thru-hole Reflow Soldering)

**Rotor:**  
0=Flat Arrow  
1=0.5mm (Minus Slot)  
3=3mm (Minus Slot)  
7=7mm (Minus Slot)  
6=Knob+3mm (Minus Slot)

**Code:**  
R=Real Code  
C=Complement Code

**Position:**  
08=Octal 8 Position  
10=BCD 10 Position  
16=Hexa 16 Position

**Pin Out:**  
2=3+2  
3=3+3  
4=4+1

**Special Code:**  
None=Standard  
W=White Color  
K=Black Color

**Rotary Switch 10x10mm**

**Specifications**

- ◆ Rating .....5VDC 100mA Max. / 20mVDC 1 μ A Min.
- ◆ Contact Resistance .....100mΩ Max.
- ◆ Insulation Resistance .....100 MΩ Max. at 100 VDC
- ◆ Dielectric Strength .....250 VAC / 1 minute
- ◆ Operating Force .....250gf/cm
- ◆ Mechanical Life .....20,000 Steps
- ◆ Operation Temperature .....-25 ~ +75
- ◆ Waterproof

<b>MODEL</b>	<b>SPECIFICATION</b>	SP-002	Page
<b>R9 Series Thru Hole</b>			RoHS Compliant -Rotary Coded Switch

**Materials:**

- ◆ Cover & Base            R9.....Thermoplastic UL94-HB, (Blue)  
                                  R9W.....Thermoplastic UL94-V0, (White)  
                                  R9K.....Thermoplastic UL94-V0, (Black)
- ◆ Rotor                        R93/R92.....Thermoplastic UL94-HB, (White/Red)  
                                  R94.....Thermoplastic UL94-HB, (Gray/Green)
- ◆ Knob                        .....PC
- ◆ "O" Ring                    .....Silicone Rubber
- ◆ Step                         .....Stainless Steel
- ◆ Spacer                      .....Stainless Steel
- ◆ Movable Contact         .....Cooper alloy with Gold Plated over nickel plate
- ◆ Terminal Contact        .....Copper alloy with Gold Plated over nickel plate
- ◆ Terminal                    .....Cooper alloy with (Pure) Tin-Plated over nickel plate

**Code Format:**

No. of Positions		16 Positions																
		10 Positions																
		08 Postions																
Position		0	1	2	3	4	5	6	7	8	9	A	B	C	D	E	F	
Code	Real Code	8								●	●	●	●	●	●	●	●	
		4				●	●	●	●					●	●	●	●	
		2			●	●			●	●			●	●			●	●
		1		●		●		●		●		●		●		●		●
	Complementary Code	8	●	●	●	●	●	●	●	●								
		4	●	●	●	●					●	●	●	●				
		2	●	●			●	●			●	●			●	●		
		1	●		●		●		●		●		●		●		●	

<b>MODEL</b>	<b>SPECIFICATION</b>	SP-003	Page
<b>R9 Series Thru Hole</b>			RoHS Compliant -Rotary Coded Switch

### Position

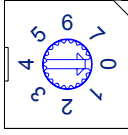
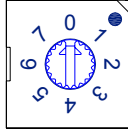
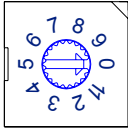
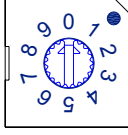
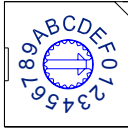
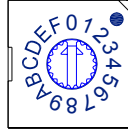
8 Position		10 Position		16 Position	
R93	R94	R93	R94	R93	R94
					

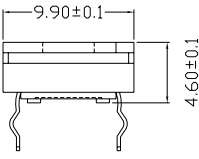
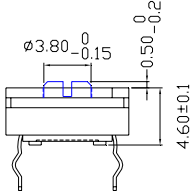
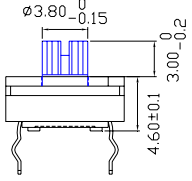
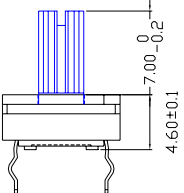

### Rotor

H Type

Flat Type	0.5mm	3mm	7mm
			

### Rotor Color

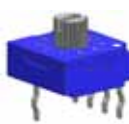
H Type

Real Code		Complement Code	
R93/R92 (White)	R94 (Gray)	R93/R92 (Red)	R94 (Green)
			

<b>MODEL</b> <b>R9 Series</b> <b>Thru Hole</b>	<b>SPECIFICATION</b> <b>RoHS Compliant -Rotary Coded Switch</b>	<b>SP-004</b>	<b>Page</b>  4/6
--	--	---------------	------------------------

### R92-H

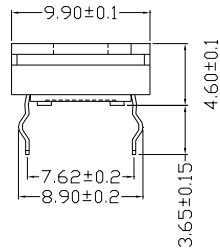
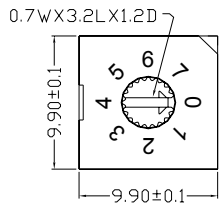

TERMINATION IDENTIFICATION  
VIEWED FROM BOTTOM OF SWITCH

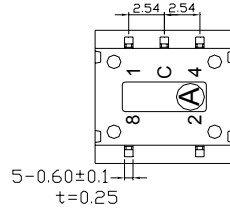

PC LAYOUT (TOP VIEW)

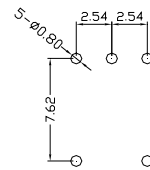

### R93-H

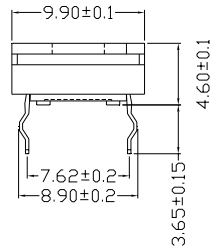
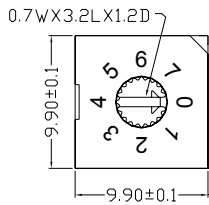
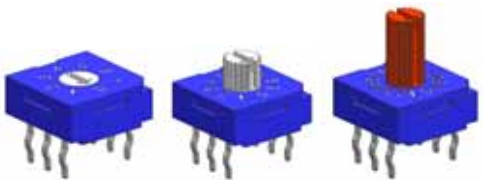

TERMINATION IDENTIFICATION  
VIEWED FROM BOTTOM OF SWITCH

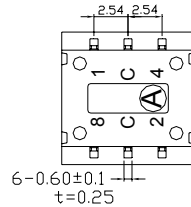

PC LAYOUT (TOP VIEW)

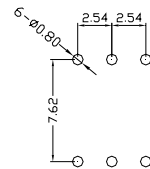

### R94-H

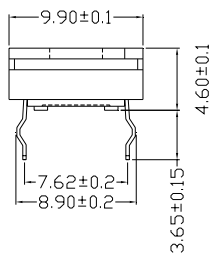
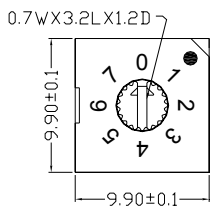

TERMINATION IDENTIFICATION  
VIEWED FROM BOTTOM OF SWITCH

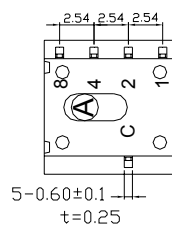

PC LAYOUT (TOP VIEW)

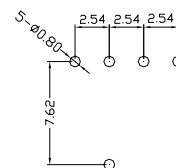

<b>MODEL</b>	<b>SPECIFICATION</b>	SP-005	Page
R9 Series Thru Hole			RoHS Compliant -Rotary Coded Switch

### Soldering Information

◆ **Hand Soldering**

Soldering iron 30W or under at 350 for 3 sec max or at 270 for 5 sec max.

◆ **Wave Soldering**

For lead free wave solder simulation of typical components, the solder bath temperature shall be maintained to 275 .

The hold time in the solder shall be 10 +2/-0 seconds.

### Classification Wave Soldering Profiles

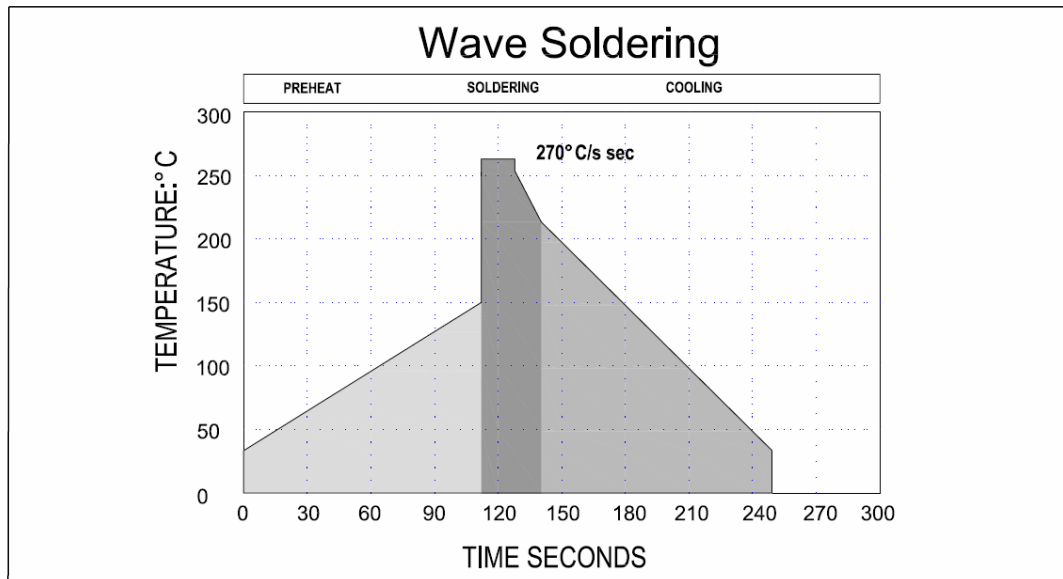

Maximum dwell time in the solder wave (270 ) shall not exceed 5 seconds.

**Part Number Table:**

Pin Out	No. Pos.	Real Code			Complementary Code		
		H Type Flat Rotor Tube Package	H Type 0.5mm Rotor Tube Package	V Type 7mm Rotor Tube Package	H Type Flat Rotor Tube Package	V Type 3mm Rotor Tube Package	H Type 7mm Rotor Tube Package
3+2	08	R9208R0H	R9208R1H	R9208R7V	R9208C0H	R9208C3V	R9208C7H
	10	R9210R0H	R9210R1H	R9210R7V	R9210C0H	R9210C3V	R9210C7H
	16	R9216R0H	R9216R1H	R9216R7V	R9216C0H	R9216C3V	R9216C7H
3+3	08	R9308R0H	R9308R1H	R9308R7V	R9308C0H	R9308C3V	R9308C7H
	10	R9310R0H	R9310R1H	R9310R7V	R9310C0H	R9310C3V	R9310C7H
	16	R9316R0H	R9316R1H	R9316R7V	R9316C0H	R9316C3V	R9316C7H
4+1	08	R9408R0H	R9408R1H	R9408R7V	R9408C0H	R9408C3V	R9408C7H
	10	R9410R0H	R9410R1H	R9410R7V	R9410C0H	R9410C3V	R9410C7H
	16	R9416R0H	R9416R1H	R9416R7V	R9416C0H	R9416C3V	R9416C7H

**Tube Package:**

Thru Hole ROTOR	H Type Flat / 0.5mm	H Type 3mm / 7mm
Per TUBE (pcs)	50	50
BOX (pcs)	4000	2500
CTN 1 (pcs)	8000	5000
CTN 2 (pcs)	16000	10000

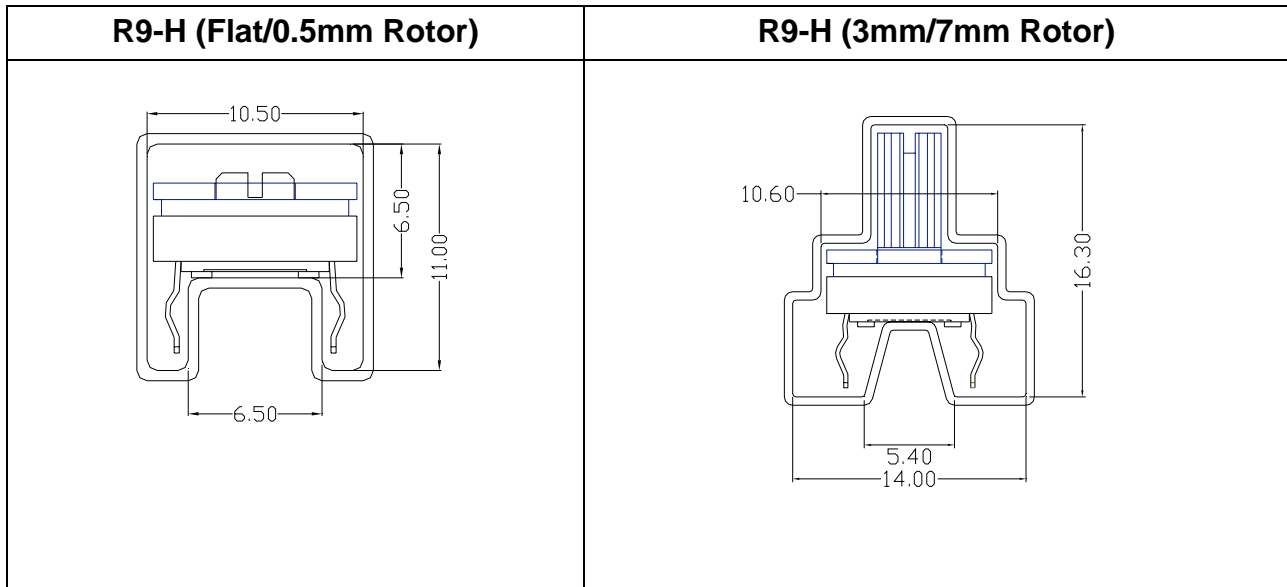

**Carton:**

- ◆ Tube                      CTN1 / 2 Boxes.....58.5cm x 26.5cm x 16cm
- CTN2 / 4 Boxes.....58.5cm x 26.5cm x 24cm